

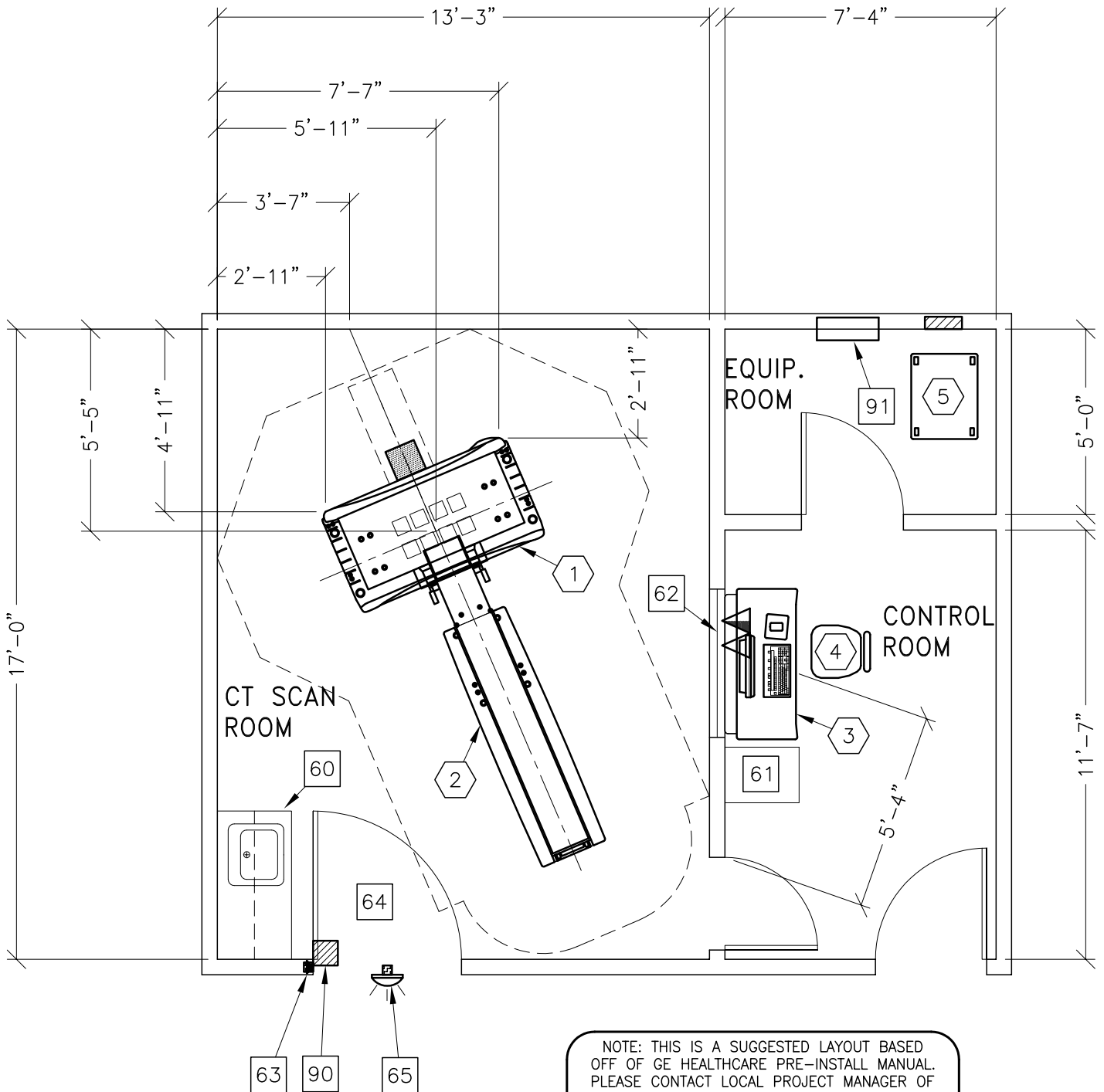

CT HiSpeed Dual  
**RECOMMENDED CEILING HEIGHT**  
**9'-0" [2743mm]**



NOTE: THIS IS A SUGGESTED LAYOUT BASED OFF OF GE HEALTHCARE PRE-INSTALL MANUAL. PLEASE CONTACT LOCAL PROJECT MANAGER OF INSTALLATION IF YOUR ROOM LAYOUT OR DIMENSIONS ARE DIFFERENT THAN THE LAYOUT SHOWN.

ROOM DIMENSIONS	LENGTH & WIDTH	CEILING HEIGHT
MINIMUM:	19'-6" x 17'-0" [5.94m x 5.18m]	7'-6" [2.28m]

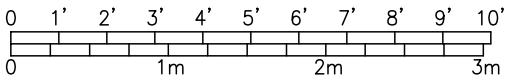

SEE APPENDIX "A" FOR POWER SPECIFICATIONS

ROOM PLAN LOCATED ON PAGE 6-60

ITEM	QUANTITY	ITEM DESCRIPTION	WEIGHT	HEAT OUTPUT
①	1	CT/e GANTRY	2213 lbs	9897 btu
②	1	PATIENT TABLE	551 lbs	395 btu
③	1	HISPEED DUAL OPERATORS CONSOLE	220 lbs	2935 btu
④	1	OPERATOR'S CHAIR		
⑤	1	POWER DISTRIBUTION UNIT	346 lbs	614 btu
***** <b>CUSTOMER/CONTRACTOR SUPPLIED AND INSTALLED ITEMS</b> *****				
60		COUNTER TOP WITH SINK, BASE AND WALL CABINETS		
61		COUNTER TOP FOR EQUIPMENT- PROVIDE GROMMETED OPENINGS AS REQUIRED TO ROUTE INTERCONNECT CABLES TO RACEWAY BELOW COUNTERTOP.		
62		LEAD GLASS WINDOW		
63		DOOR LIMIT SWITCH (REQUIRED IN SOUTH CAROLINA, OTHERWISE NEEDED ONLY IF REQUIRED BY STATE/LOCAL CODES)		
64		MINIMUM DOOR OPENING FOR EQUIPMENT DELIVERY IS 42 IN. W x 82 IN. H [1067mm x 2083mm], CONTINGENT ON A 96 IN. [2438mm] CORRIDOR WIDTH		
65		X-RAY ON WARNING LIGHT - AVAILABLE FROM GE SUPPLY CALL: 800-200-9760 GE CAT. NO. WXIABWW-DF-XIU		
90		X-RAY ROOM WARNING LIGHT CONTROL PANEL REFERENCE JUNCTION POINT 'WLC' ON SHEET 'E1' FOR DETAILED DESCRIPTION -E4502RL FOR WARNING LIGHT CONTROL ONLY.		
91		MAIN DISCONNECT CONTROL GEMS CAT. NO. E4502AD 90 lbs., SEE DETAIL R4502AD.		

ENVIRONMENT

Ambient Operation Temperature: 60-75° F (16° TO 24° C)  
 Allowable Temperature Change: 5° F (3° C) per hour  
 Humidity: 30-60% non condensing  
 Allowable Humidity Change: 10% per hour  
 Max - Altitude: 10,000 ft. above sea level